

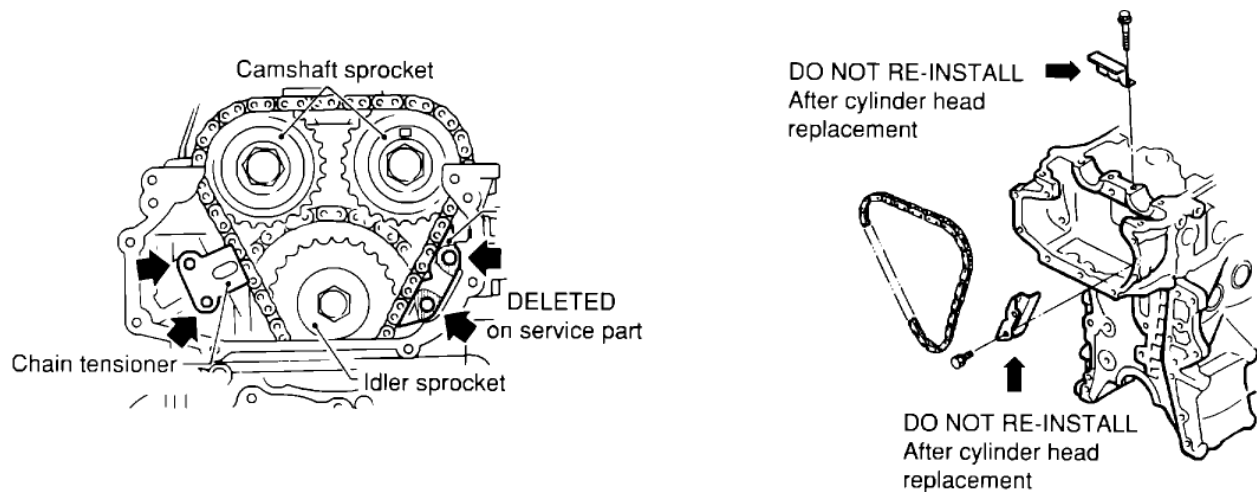

**Timing Chain Guide Elimination On
1991-93 1.6L DOHC Nissan Engines**

The AERA Technical Committee has received information concerning the elimination of two timing chain guides on 1991-93 1.6L DOHC engines. Beginning with engines produced in March 1993, the top and left side timing chain guides were eliminated.

All replacement cylinder heads Part #11040-57Y01, will not have the drilled holes to attach the chain guides. Those guides are not necessary and may cause an undesirable rattling noise when the timing chain contacts the guide. To prevent a possible noise complaint, Nissan suggests removing the two guides shown in the illustrations below anytime cylinder head repair is done.



The AERA Technical Committee

This information is provided from the best available sources. However, AERA does not assume any responsibility for data accuracy or consequences of its application. Members and others are not authorized to reproduce or distribute this material in any form, or issue it to their branches, divisions or subsidiaries, etc. at a different location without written permission.