

**NOW
AVAILABLE!**

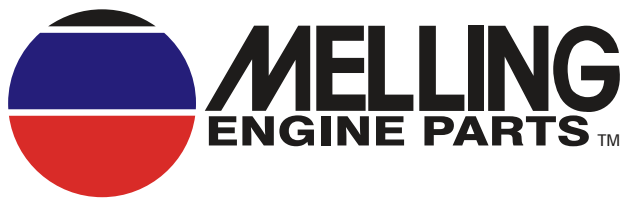

ANNOUNCES

A NEW HIGH VOLUME OIL PUMP CHRYSLER 5.7L HEMI ENGINES

CHRYSLER 5.7L (345) OHV 2005-08	300	DODGE 5.7L (345) OHV 2003-08	Ram 1500-3500
CHRYSLER 5.7L (345) OHV 2007-08	Aspen	DODGE 5.7L (345) OHV 2005	Ram 4000
DODGE 5.7L (345) OHV 2006-08	Charger	JEEP 5.7L (345) OHV 2006-08	Commander
DODGE 5.7L (345) OHV 2004-08	Durango	JEEP 5.7L (345) OHV 2005-08	Cherokee
DODGE 5.7L (345) OHV 2005-08	Magnum		

Part number

M342HV

UPC: 729295106029

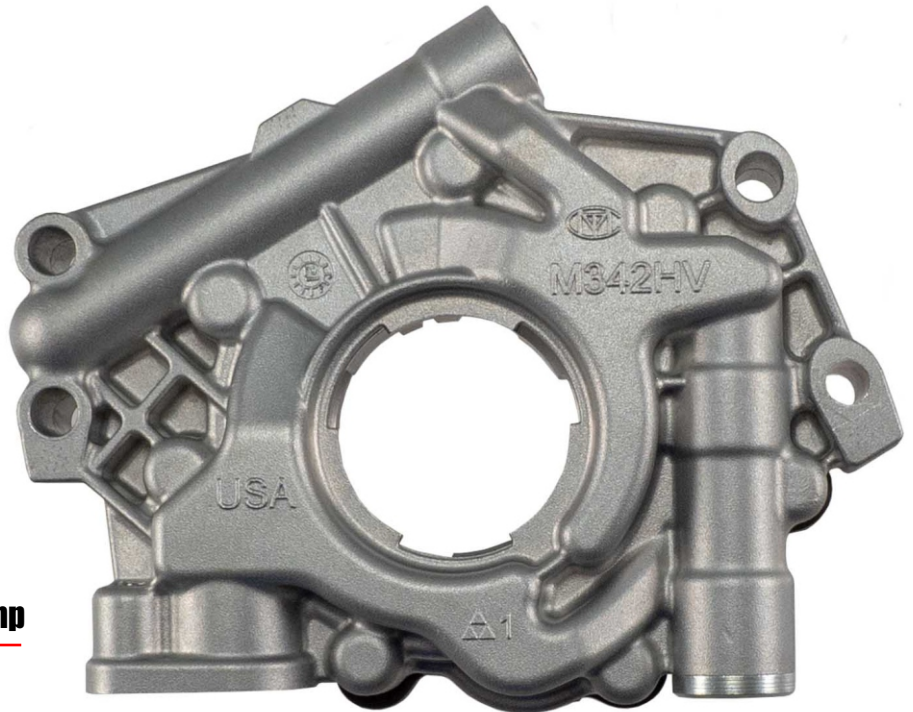

- **20% additional volume over stock pump**
- **Manufactured with 60 psi spring**
- **Includes optional 65 psi spring**
- **Includes optional 50 psi spring**
- **Recommended for high milage engines**



**** Always consult catalog listings for detailed application information****

Melling Engine Parts

P.O. Box 1188 • Jackson, MI 49204 • www.melling.com